

# SPEAKMAN®

## SE-922

### DRENCH HOSE

#### DESCRIPTION

The SE-922 counter top mounted drench hose featuring stay open valve, 6' hose and flip-top dust covers.

#### SPECIFICATIONS

**Spray Heads:** Yellow plastic spray outlets with flip-top dust caps and an automatic flow control

**Valve:** 3/8" NPT female brass, chrome-plated

**Activator:** Brass, chrome-plated squeeze handle

**Hose:** 6' reinforced

**Flange:** Brass, chrome-plated

**Inlet:** 3/8" NPT male, swivel connection

**Performance:** 1.6 gpm @ 30 psi

**Compliance:** ANSI Z358.1

#### OPTIONS

- SSHSE Stainless steel hose
- VB Vacuum breaker
- XHS Extended hose

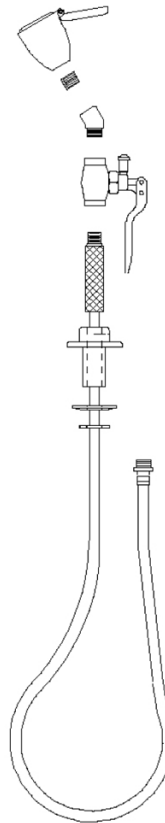

|                            |
|----------------------------|
| Job Name _____             |
| Location _____             |
| Architect/Engineer _____   |
| Sales Representative _____ |
| Wholesaler _____           |
| Date _____ Model # _____   |