

# SPEAKMAN®

## SE-582-ADA

### EYESAVER® EYE/FACE WASH

#### DESCRIPTION

The SE-582-ADA Eyesaver® wall mounted eyewash features a stainless steel bowl, dual aerated spray heads with automatic flow controls and flip top dust covers. Unit designed for ADA accessibility.

#### SPECIFICATIONS

**Bowl:** 300 series stainless steel

**Spray heads:** (2) aerated yellow plastic spray outlets with flip-top dust caps

**Valve:** ½" NPT female brass, chrome plated

**Activator:** Stainless steel push handle

**Inlet:** ½" NPT female

**Performance:** 3.6 gpm @ 30 psi

**Compliance:** ANSI Z358.1

**Universal Emergency Sign Included**



#### OPTIONS

- ☐ FPV Freeze protection valve
- ☐ SPV Scald protection valve
- ☐ FLW Flow switch
- ☐ HS Hand held spray
- ☐ PT P-Trap
- ☐ SSBV Stainless steel ball valve
- ☐ ILS In Line Strainer

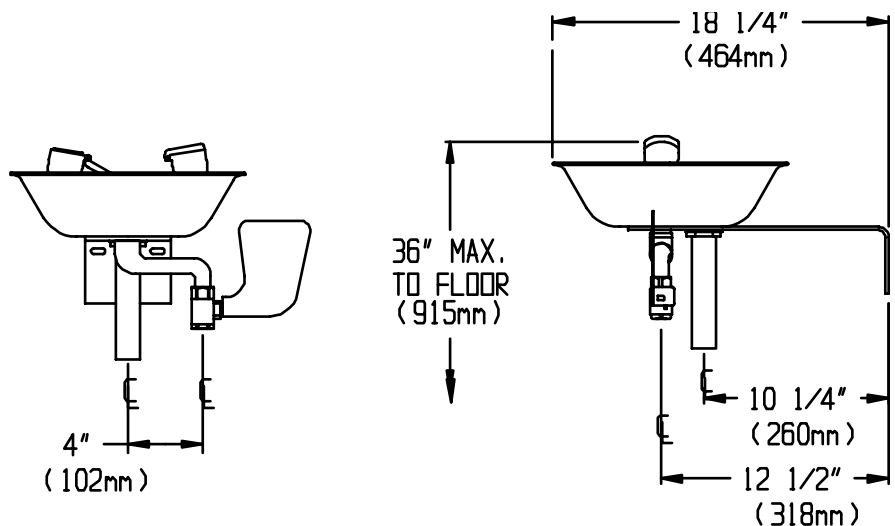

Job Name _____	
Location _____	
Architect/Engineer _____	
Sales Representative _____	
Wholesaler _____	
Date _____	Model # _____